

Model: 58

Cast Carbon Steel or Stainless Steel Full Flange Butterfly Valves Sizes: 14"–18" (650–800mm)

Pressure / Temperature – Non-Shock		
Model	Material	Rating
58D	Carbon Steel	150psi @ 100°F
58H	Stainless Steel	150psi @ 100°F

In accordance with ANSI B16.1 or B16.5
Max. temp can be limited by seat material.
See Elastomer Guide in Technical Data Section.



Model 58

Typical Service

- These soft-seated butterfly valves are designed for a variety of general applications in the control of water, steam, air, oil, gases, and corrosive media.
- They are equally effective for on-off, throttling, isolation, and dead end requirements.
- They are especially well suited for higher velocity service and vacuum service to 28" Hg.

Features

- Dual durometer seat features a tough wear resistant elastomer bonded to a phenolic backup ring.
 - The soft elastic seat portion provides positive sealing
 - The backup ring provides strength for vacuum or high velocity services
 - The combination eliminates the need for flange gaskets
- Stem seals include a primary seal between the disc hub and the seat hub, along with secondary O-ring seals at the top and bottom of the seat
 - This retains lubrication and prevents corrosion from outside elements.
- Stem is retained in the body for blowout proof design
- Many material options available. See How to Order page in the Butterfly Valve section of the Mueller Steam Specialty Engineering binder for standard materials and ordering instructions
- A variety of operators can be supplied
 - Multi-position lever operator
 - Gear Operator
 - Pneumatic, hydraulic, or electric actuators with solenoids, limit switches, positioners and more, consult factory

Construction

- ANSI 150 Flange Design
- Available in 14", 16", and 18" sizes

Performance Considerations

- Seat selections will limit temperature range
- Seat and body materials must be chosen carefully for compatibility with corrosive media applications.
- Guidelines for throttling service:
 - Liquids - Line velocity should not exceed 20 ft/sec
 - Gases - Line velocity should not exceed 15,000 ft/min.

Materials

	58D	58H
Body	Carbon Steel ASTM A216 WCB	Stainless Steel ASTM A351 CF8M
Stem	316 SS	316 SS
Disc	316 SS	316 SS
Seat	EPDM	EPDM
O-Ring Seals	EPDM	EPDM

Job Name _____

Job Location _____

Engineer _____

Approval _____

Contractor _____

Approval _____

Contractor's P.O. No. _____

Representative _____

Dimensions and Weights

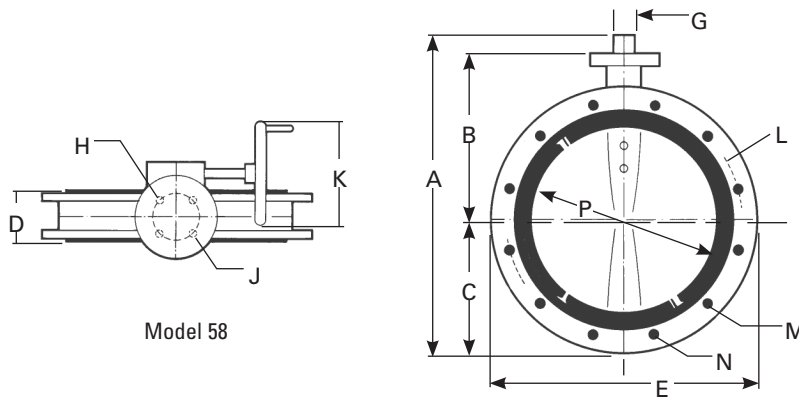

Model 58

SIZE		DIMENSIONS														WEIGHT												
		A	B	C	D	E	G	H	J	K	L	M	N	P														
in.	mm	in.	mm	in.	mm	in.	mm	in.	mm	in.	mm	in.	mm	in.	mm	# of Holes	in.	mm	lbs.	kgs.								
Model 58																												
14	350	25 ³ / ₄	654	13 ¹ / ₈	333	10 ⁹ / ₁₆	264	3 ⁵ / ₈	92	17 ³ / ₄	450	1 ¹ / ₂	38	4 ³ / ₄	121	⁴ / ₈	14	16	406	18 ³ / ₄	476	1-8	3	12	13 ¹ / ₄	337	160	73
16	400	29 ⁵ / ₁₆	738	14 ¹ / ₂	368	12 ¹ / ₂	308	4 ¹ / ₈	105	20 ¹ / ₄	514	1 ¹ / ₂	38	6	125	¹¹ / ₁₆	17	16	406	21 ¹ / ₄	540	1-8	3	16	15 ¹ / ₄	378	231	105
18	450	32	813	16	406	13	330	4 ⁵ / ₈	117	21 ⁵ / ₈	549	2	51	7 ¹ / ₂	191	⁵ / ₈	16	16	406	22 ³ / ₄	578	1 ¹ / ₈ -7	29	16	17 ¹ / ₄	438	286	130

Mueller Steam Specialty product specifications in U.S. customary units and metric are approximate and are provided for reference only. For precise measurements, please contact Mueller Steam Specialty Technical Service. Mueller Steam Specialty reserves the right to change or modify product design, construction, specifications, or materials without prior notice and without incurring any obligation to make such changes and modifications on Mueller Steam Specialty products previously or subsequently sold.

