

## For Point-of-Use Water Applications

Job Name \_\_\_\_\_

Contractor \_\_\_\_\_

Job Location \_\_\_\_\_

Approval \_\_\_\_\_

Engineer \_\_\_\_\_

Contractor's P.O. No. \_\_\_\_\_

Approval \_\_\_\_\_

Representative \_\_\_\_\_

# 10 Series Quick-Connect Connectors

Sea Tech Quick-Connect Connectors are designed and manufactured for many years of trouble free service. Produced of off white polypropylene, a high performance thermoplastic material, the Sea Tech Quick-Connect design allows for quick and easy connections without the use of installation tools.

### Specifications

Connection shall be made using Sea Tech 10 Series Quick-Connect fitting with Integral Collet and O-Ring Guide. Fitting shall be able to fully rotate under pressure and allow easy disconnect and reuse without the use of disconnection tools. Fitting must not disassemble to disconnect.

### Approvals

NSF-61

### Ratings

150psi @ 70°F (10 bar @ 20°C)

60psi @ 140°F (4 bar @ 60°C) Min. 33°F (1°C)

### Example

#### 1014R-0604

10 = Series 10

14 = Reducing Stem

R = Reducing

0604 = 3/8" OD x 1/4" OD

**Caution:** The polypropylene material used in the Quick-Connect fittings can be compromised by exposure to volatile organic compounds (VOC's) and caustic chemicals. Therefore, **DO NOT** expose this product to any such chemical or foreign substance, which would include exposure to the following products: **Pipe Dopes (thread sealants)**, bug sprays, lubricants, cleaners, paints, bleaches, acids, solder fluxes, plastic piping primers and cements, oxidizing agents, alkaline solutions, thinners, fuels, oil based caulks, hydrocarbons, spray foam or foaming agents (insulation).



1001



1010



1014R



1015



1015R



1027

Sea Tech product specifications in U.S. customary units and metric are approximate and are provided for reference only. For precise measurements, please contact Sea Tech Technical Service. Sea Tech reserves the right to change or modify product design, construction, specifications, or materials without prior notice and without incurring any obligation to make such changes and modifications on Sea Tech products previously or subsequently sold.

## Dimensions – Weights approx. (tolerance +/- 1/8")

### Type 01 Male Connectors

MODEL	SIZE & CONNECTION	ITEM LENGTH		ITEM HEIGHT		ITEM WEIGHT	
		A		B		lbs.	kg.
		<i>in.</i>	<i>mm</i>	<i>in.</i>	<i>mm</i>		
1001-0402	¼" OD x ⅛" NPTF	1½	26	1¾	20	0.20	5.67
1001-0404	¼" OD x ¼" NPTF	1¾	30	1¾	20	0.20	5.67
1001-0406	¼" OD x ⅜" NPTF	1¾	30	1¾	20	0.20	5.67
1001-0408	¼" OD x ½" NPTF	1½	37	1¾	21	0.30	8.50
1001-0602	⅜" OD x ⅛" NPTF	1¾	36	1¾	21	0.21	5.90
1001-0604	⅜" OD x ¼" NPTF	1¾	39	1¾	21	0.30	8.50
1001-0606	⅜" OD x ⅜" NPTF	1¾	39	1¾	21	0.30	8.50
1001-0608	⅜" OD x ½" NPTF	1½	43	1¾	21	0.30	8.50
1001-0806	½" OD x ⅜" NPTF	1½	41	1	25	0.40	11.34
1001-0808	½" OD x ½" NPTF	1½	45	1	25	0.40	11.34

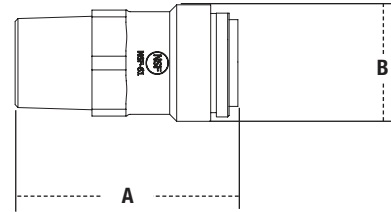

### Type 10 Female Connectors

MODEL	SIZE & CONNECTION	ITEM LENGTH		ITEM HEIGHT		ITEM WEIGHT	
		A		B		lbs.	kg.
		<i>in.</i>	<i>mm</i>	<i>in.</i>	<i>mm</i>		
1010-0401	¼" OD x 7/16" UNS	1½	38	7/8	22	0.32	9.07
1010-0601	⅜" OD x 7/16" UNS	1¾	39	7/8	22	0.29	8.16
1010-0404	¼" OD x ¼" NPTF	1½	38	7/8	22	0.29	8.16
1010-0604	⅜" OD x ¼" NPTF	1¾	39	7/8	22	0.24	6.80

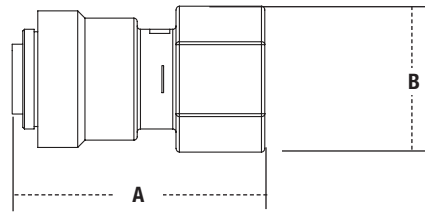

### Type 14 Reducing Stems

MODEL	SIZE & CONNECTION	ITEM LENGTH		ITEM HEIGHT		ITEM WEIGHT	
		A		B		lbs.	kg.
		<i>in.</i>	<i>mm</i>	<i>in.</i>	<i>mm</i>		
1014R-0604	⅜" OD x ¼" OD	1¾	43	1½	16	0.20	5.67

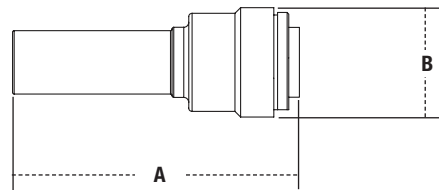

### Type 15 Union Connectors

MODEL	SIZE & CONNECTION	ITEM LENGTH		ITEM HEIGHT		ITEM WEIGHT	
		A		B		lbs.	kg.
		<i>in.</i>	<i>mm</i>	<i>in.</i>	<i>mm</i>		
1015-04	¼" OD	1½	41	1½	16	0.20	5.67
1015-06	⅜" OD	1½	49	1¾	21	0.30	8.50
1015-08	½" OD	2¼	56	1"	24	0.50	14.17

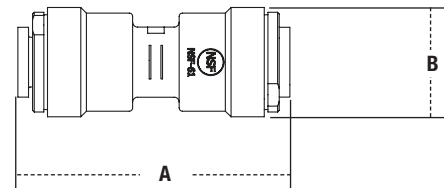

### Type 15R Reducing Union Connectors

MODEL	SIZE & CONNECTION	ITEM LENGTH		ITEM HEIGHT		ITEM WEIGHT	
		A		B		lbs.	kg.
		<i>in.</i>	<i>mm</i>	<i>in.</i>	<i>mm</i>		
1015R-0604	⅜" OD x ¼" OD	1¾	48	1¾	21	0.30	8.50
1015R-0806	½" OD x ⅜" OD	2¼	56	1"	24	0.51	14.51

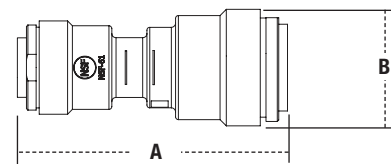

### Type 27 Male Stem

MODEL	SIZE & CONNECTION	ITEM LENGTH		ITEM HEIGHT		ITEM WEIGHT	
		A		B		lbs.	kg.
		<i>in.</i>	<i>mm</i>	<i>in.</i>	<i>mm</i>		
1027-0402	¼" OD x ⅛" NPTF	1½	46	1¾	20	0.20	5.67
1027-0404	¼" OD x ¼" NPTF	1½	50	1¾	20	0.20	5.67
1027-0604	⅜" OD x ¼" NPTF	2½	65	1¾	21	0.30	8.50
1027-0606	⅜" OD x ⅜" NPTF	2½	65	1¾	21	0.30	8.62
1027-0806	½" OD x ⅜" NPTF	2¾	69	1"	26	0.42	11.79

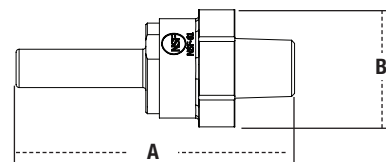

A Subsidiary of Watts Water Technologies, Inc.



USA: 211 Racine Drive, Suite 201, Wilmington, NC 28403; www.seatechinc.com

Tel: 1-888-500-0056 • Fax: 1-888-500-0057